

Diaphragm shock assembly instructions

Step 1

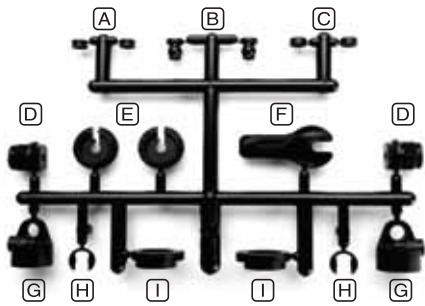

- (A) Shock cartridge cap
- (B) Shock cap bushing
- (C) Spacer
- (D) Shock cartridge
- (E) Spring cup
- (F) Tool
- (G) Shock cap
- (H) Shock cartridge C-clip
- (I) Shock adjustment nut
- (J) Shock piston

1:1 scale oring standard grid

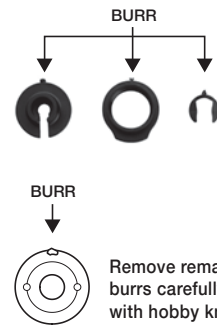
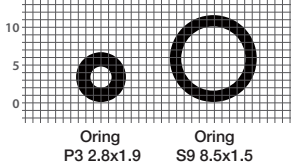

Step 2

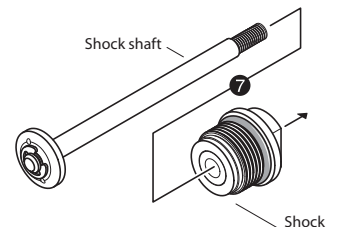
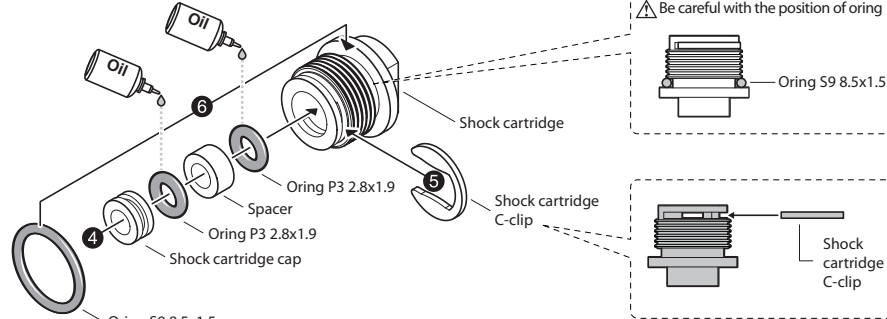
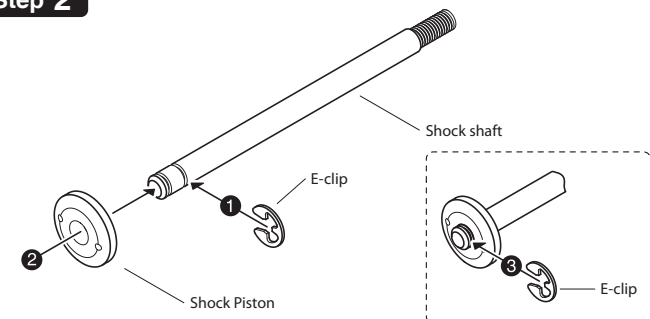

Step 3

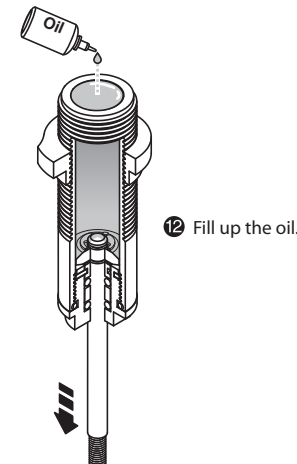
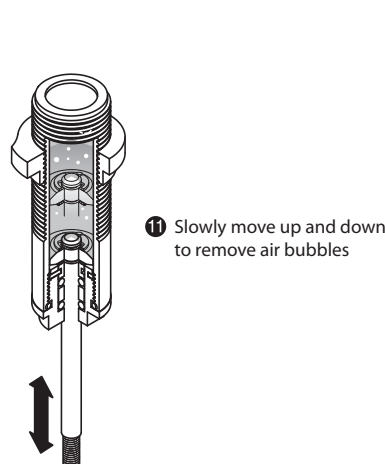
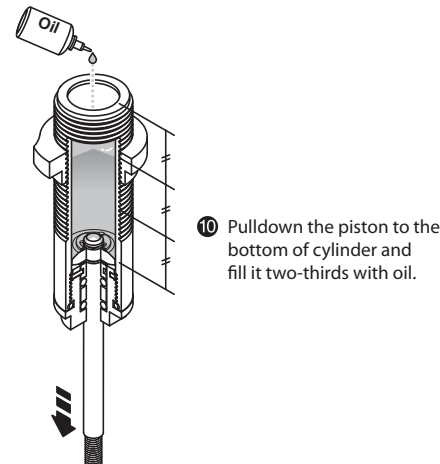
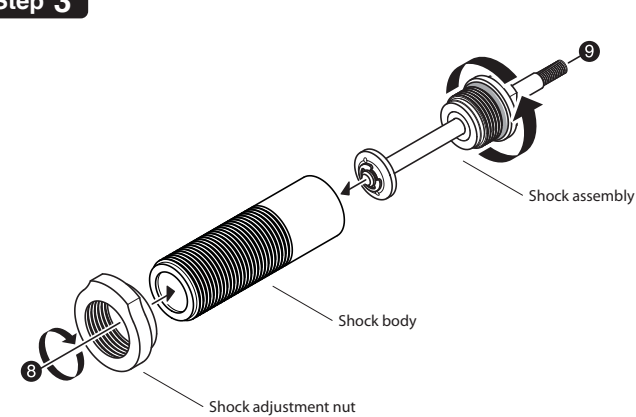

Step 4

Low pressure setup

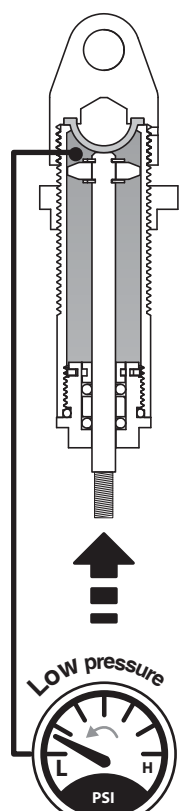
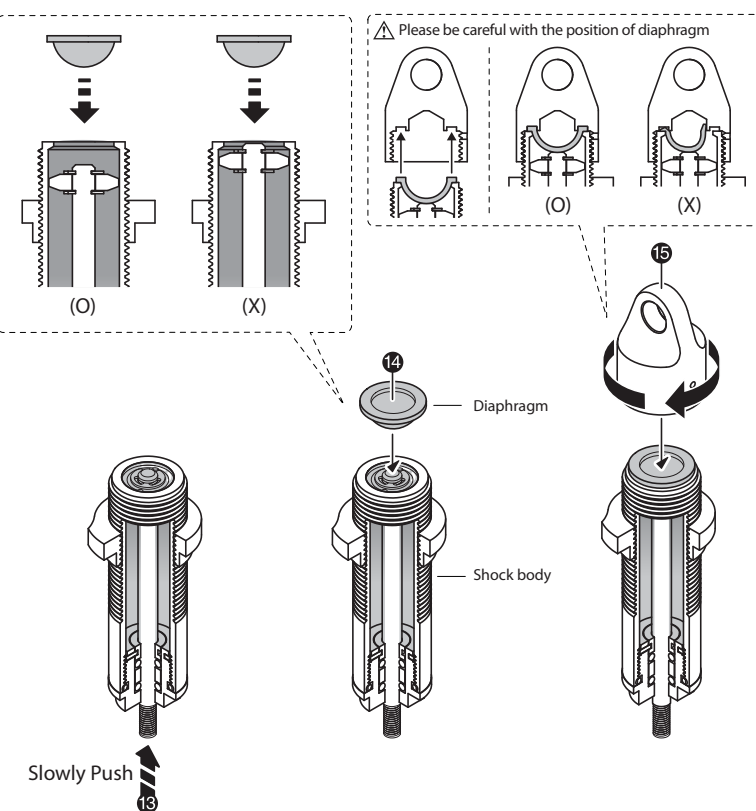

High pressure setup

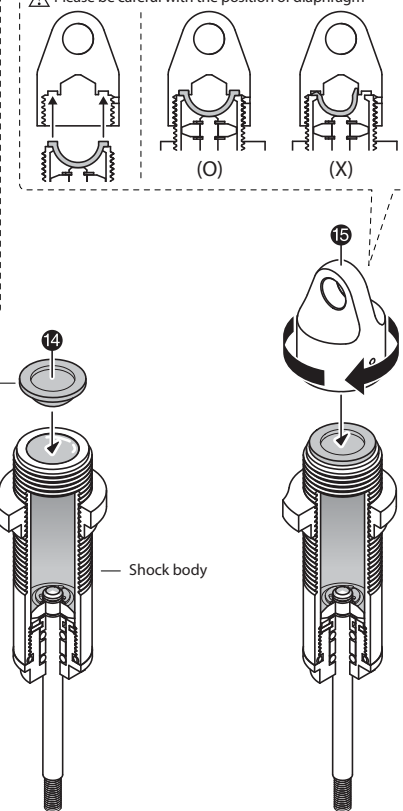
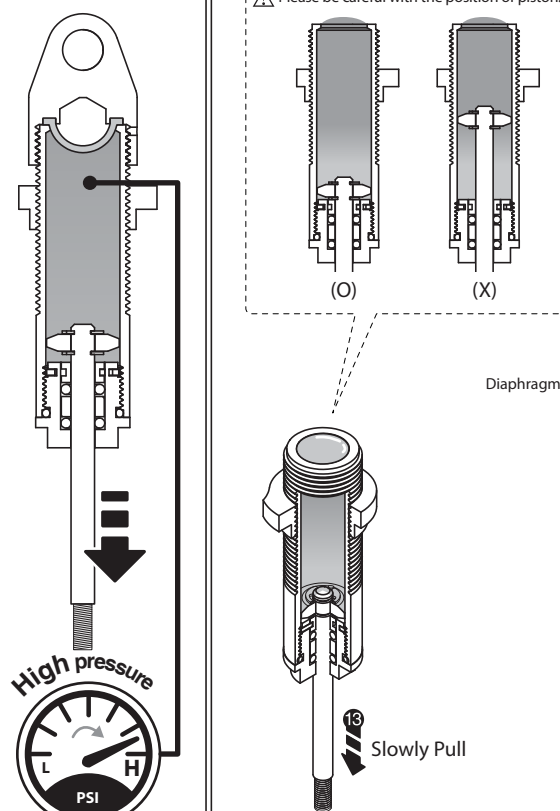

Step 5

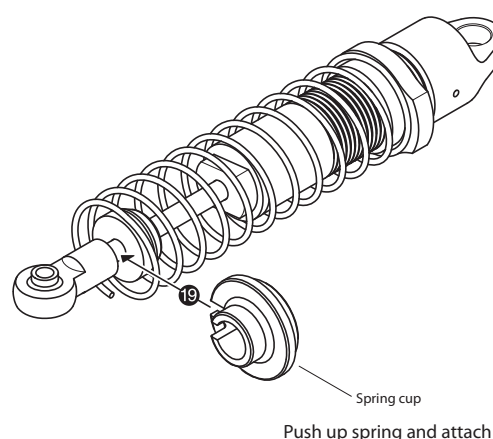
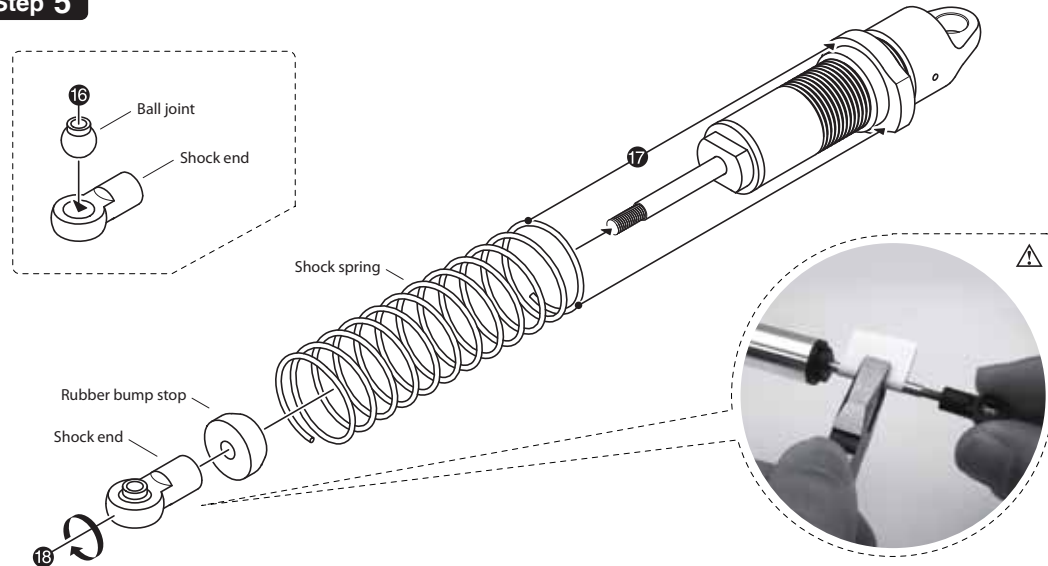

Video manual
www.gmade.net

For any inquiry or detailed
assembly explanation,
Please visit our
Gmade website.

GMade®
www.gmade.net

Made in Korea