



# PIGGY-BACK SHOCK ASSEMBLY INSTRUCTIONS



Made in Korea **GMADE**®  
www.gmade.net

Step  
**1**

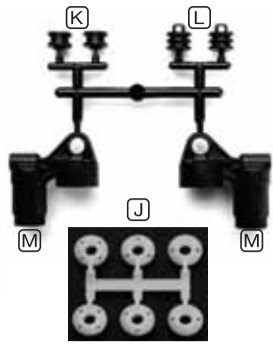
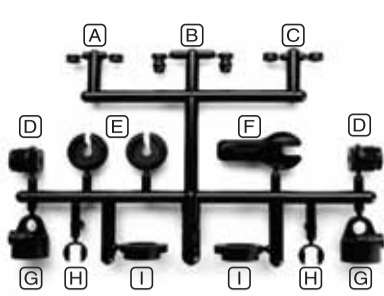

- A Shock cartridge cap
- B Shock cap bushing
- C Spacer
- D Shock cartridge
- E Spring cup
- F Tool
- G Shock cap
- H Shock cartridge C-clip
- I Shock adjustment nut
- J Shock piston
- K Piggy-back bushing
- L Piggy-back piston
- M Piggy-back shock cap

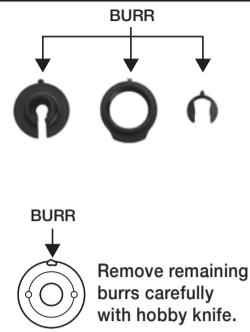
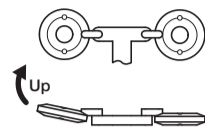

1:1 scale oring standard grid

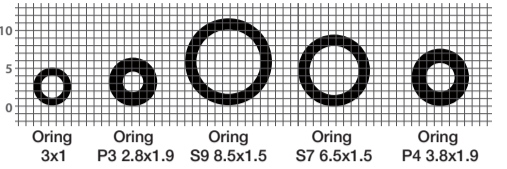

Step  
**2**

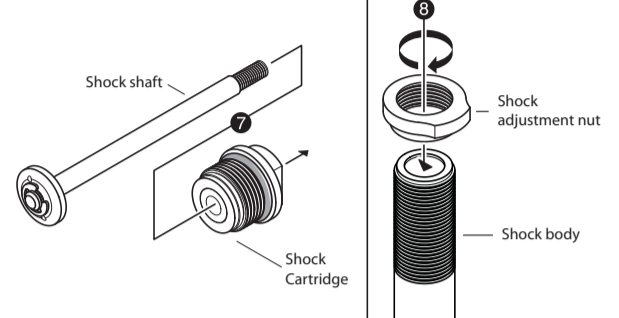
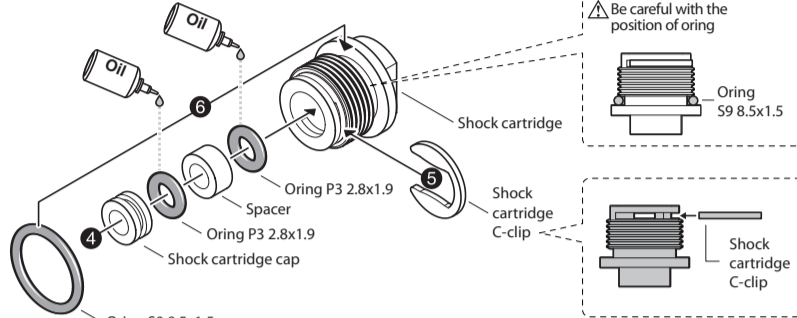
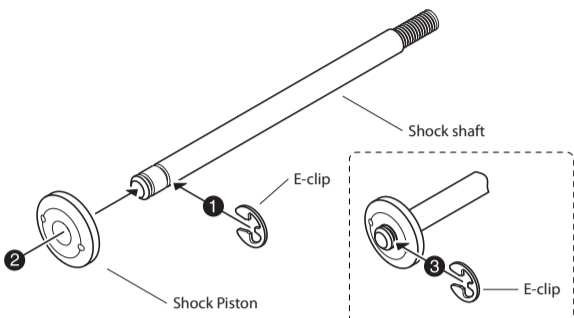

Step  
**3**

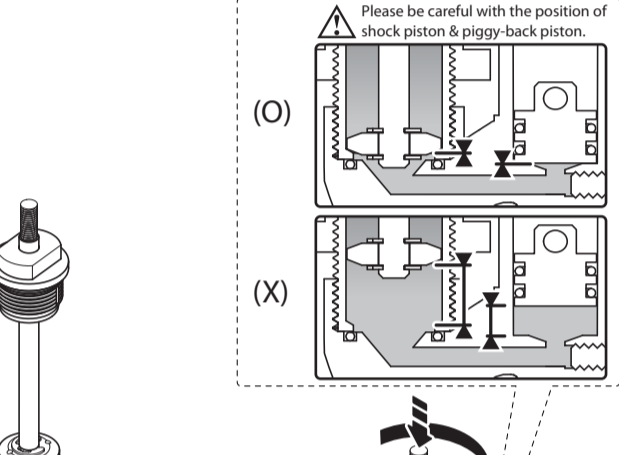
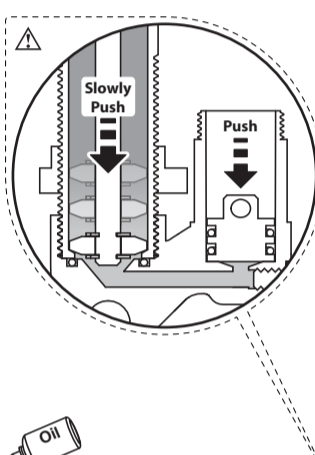
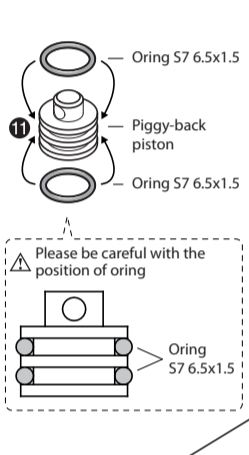
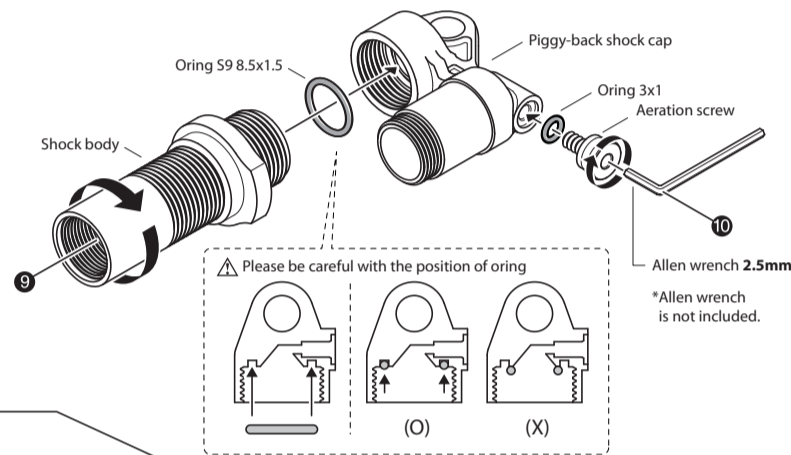

12 Fill in the shock cylinder with oil in proper amount and wait until the piggy-back cylinder will be filled with oil.

13 When oil is full in the piggy-back cylinder, push in piggy-back piston into the piggy-back cylinder.

14 Fill the shock cylinder with oil to top of thread.

15 While pushing down the piggy-back piston, press in shock piston slowly all the way to bottom.

16 While pusing in both the piggy-back piston and shock shaft, tighten cartridge slowly.

Step  
**4**

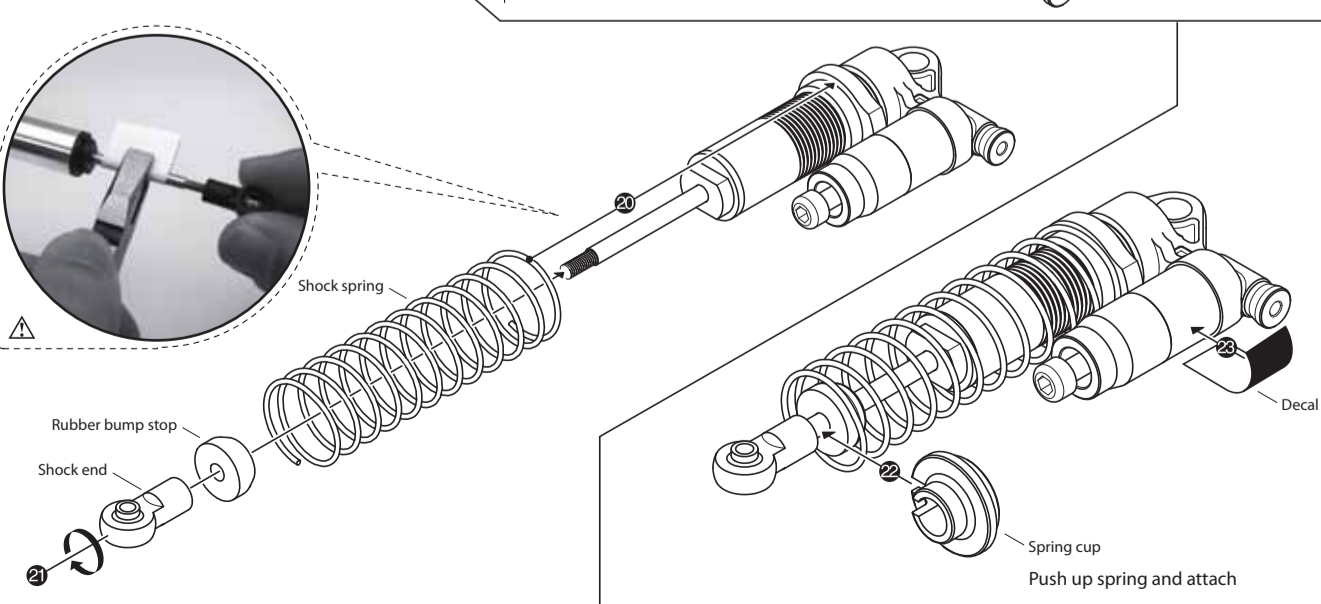
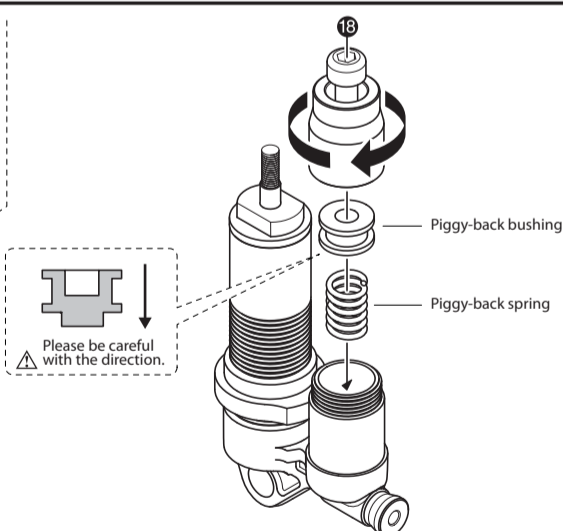
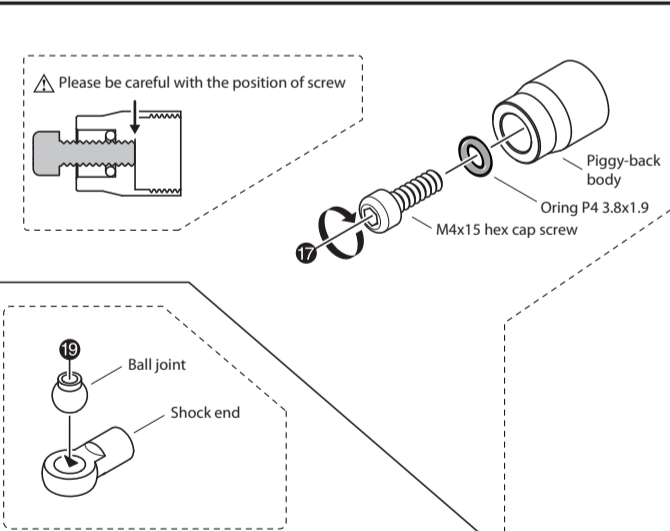

## Piggy - back Pressure setting

By screwing the hex cap screw a little tightly or loosely, the internal pressure of cylinder can be adjusted.

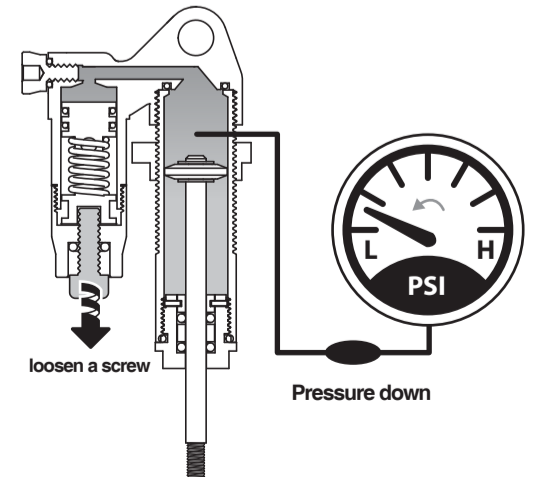
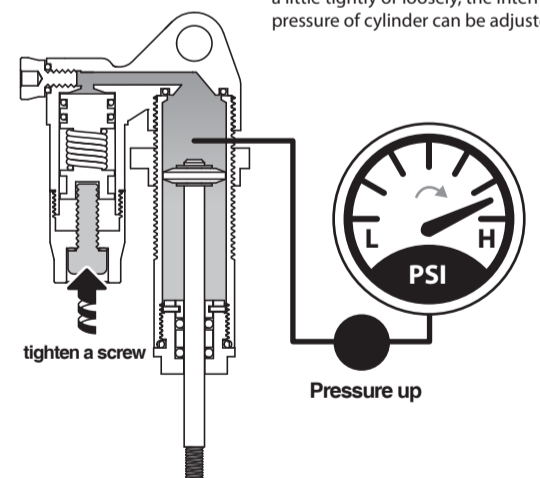

For any inquiry or detailed assembly explanation, Please visit our Gmade website. **Video manual** www.gmade.net